

67" TAIRO ACRYLIC FREESTANDING TUB

Cat. No.
ATDRSN67RIG-XX



Features:

- ▶ Acrylic construction for lighter weight
- ▶ Sleek contemporary design
- ▶ Drain and overflow covers included (available in 6 finishes)
- ▶ Rim measurement: 1-1/2"
- ▶ Overflow slot with integrated drain
- ▶ Drain included
- ▶ No faucet holes
- ▶ Includes build-in adjusters
- ▶ Angle slope of tub: 27°
- ▶ IAMPO certified
- ▶ Tub is thoroughly inspected before shipment
- ▶ Option to add foam insulation between tub walls available



L: 67"
W: 31-1/2"
H: 27" highest, 24" lowest

Water depth: 18-1/2" to top of tub
Water depth: 15" to overflow
Overflow hole diameter: 3" x 1/2"
Center of drain to back of rim: 15-3/4"
Bottom of drain to floor: 3-1/2"
Bathing well to floor: 5-1/2"

Finishes:

WT White
CP Polished Chrome
BN Brushed Nickel
PN Polished Nickel
ORB Oil Rubbed Bronze
PB Polished Brass

Custom Colors Available (inside of tub is always white enamel):
Painted bathtubs are considered "special order" and are not returnable
\$160 Bisque or Black \$250 Designer Color

The following is recommended for
ATDRSN67RIG-WH:
•Faucets: part # 7082, or #7088
•Rigid, freestanding supplies: part #4502
•Freestanding filler: part #7902 or #7934
(Supplies included with filler)



For easier installation we
recommend use of 5598-ITD
Easy Install Rough In Kit

Gallon Capacity with OF: 60
Shipping Weight: 142 lbs.
Empty Weight: 82 lbs.
Filled Weight with OF: 583 lbs.

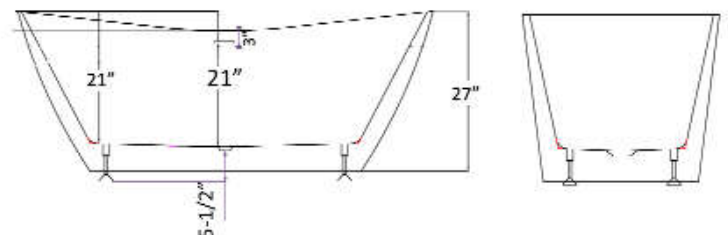
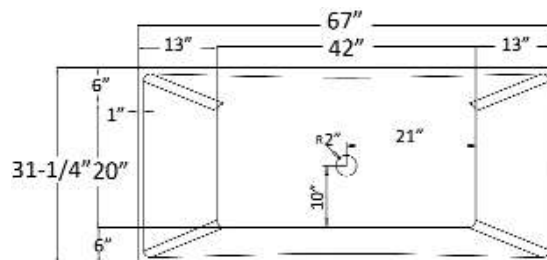

Dimensions of fixture are nominal and specifications subject to change without notice.